

Bimetal Thermometers, Every Angle

Crimped-on ring case stainless steel, turnable and adjustable

TBiGelChg
TBiGelChgG

Standard Versions

This data sheet contains detailed information on our standard versions and available options. In overview 8000 you will find additional information on selection, metrological features, permissible ambient and storage temperatures as well as error limits, etc. Information on the metrologically optimal design of thermometers can be found in our technical information sheet T08-000-031.

Measuring Unit

Bimetal coil

Accuracy (DIN EN 13 190)

Class 1

Case

With polished crimped-on ring, stainless steel 1.4301 (304)

Degree of Protection (DIN EN 60 529/IEC 529)

IP65

Case Filling

For model TBiGelChgG

Temperature ranges:

from -20 °C up to +100 °C: glycerin

from -40 °C and above +100 °C up to +250 °C: silicone oil

Nominal Case Sizes

63, 80, 100, 125, 160 mm (2 ½, 3, 4, 5, 6")

Case Configuration

Connection temperature

sensor (stem):

pivot (every angle)

Stem position:

centre back position,

compared to case approx.

135° adjustable and 360° turnable

Mounting device:

without

Temperature Ranges (DIN EN 13 190)

Temperature differences from 60 K up to 600 K

Temperature Sensor (Stem)

Made of stainless steel 1.4571 (316Ti)

Max. static operating pressure: 25 bar

Stem models: B1, B3, B4, B4.1, B5 or B6

Stem Ø dF: 6 or 8 mm

Stem length L: from Lmin or L1min up to 400 mm

Please regard the minimum stem length depending on active length (La) and stem model, see page 3

Window

Instrument glass

Dial

Aluminum white, scale black

Pointer

Aluminum black

Indication Adjustment (±4 %)

Externally via screw



Ordering Information, Standard Ranges, Options

See page 4

Special Versions and Further Options

- Other connection threads and materials upon request
- Other temperature ranges and/or special scales, e.g. dual scale °C/°F, coloured fields or ranges, dial inscriptions
- Case parts stainless steel 1.4404 (316L) upon request
- Model TBiGelChg for ambient temperatures to -60 °C
- Model TBiGelChgG for ambient temperatures to -40 °C to -60 °C NCS 100, 125 and 160
- GOST version for Russia, Ukraine, Kazakhstan, Belarus

Thermowells

See data sheets 8.8110ff.

www.armano-messtechnik.com

ARMANO

ARMANO Messtechnik GmbH

Location Beierfeld

Am Gewerbepark 9 • 08344 Grünhain-Beierfeld
Tel.: +49 3774 58 - 0 • Fax: +49 3774 58 - 545
mail@armano-beierfeld.com

Location Wesel

Manometerstraße 5 • 46487 Wesel-Ginderich
Tel.: +49 2803 9130 - 0 • Fax: +49 2803 1035
mail@armano-wesel.com

8112

09/19

Stem Position, Dimensional Data and Weights

Centre Back Stem Position, with Pivot (Every Angle)

Stem model B1 (also B5)

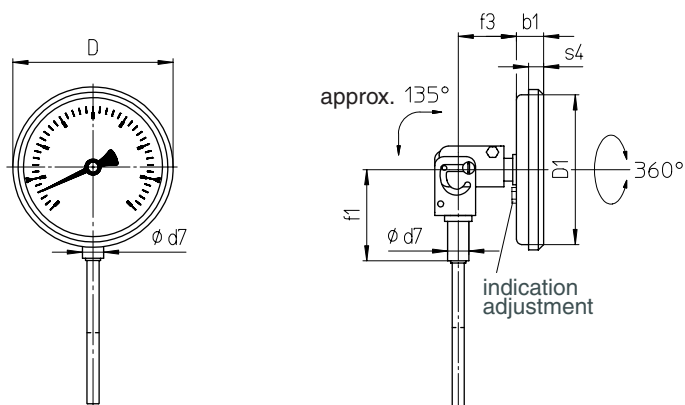

Stem model B3 (also B6)

Stem model B4

Stem model B4.1

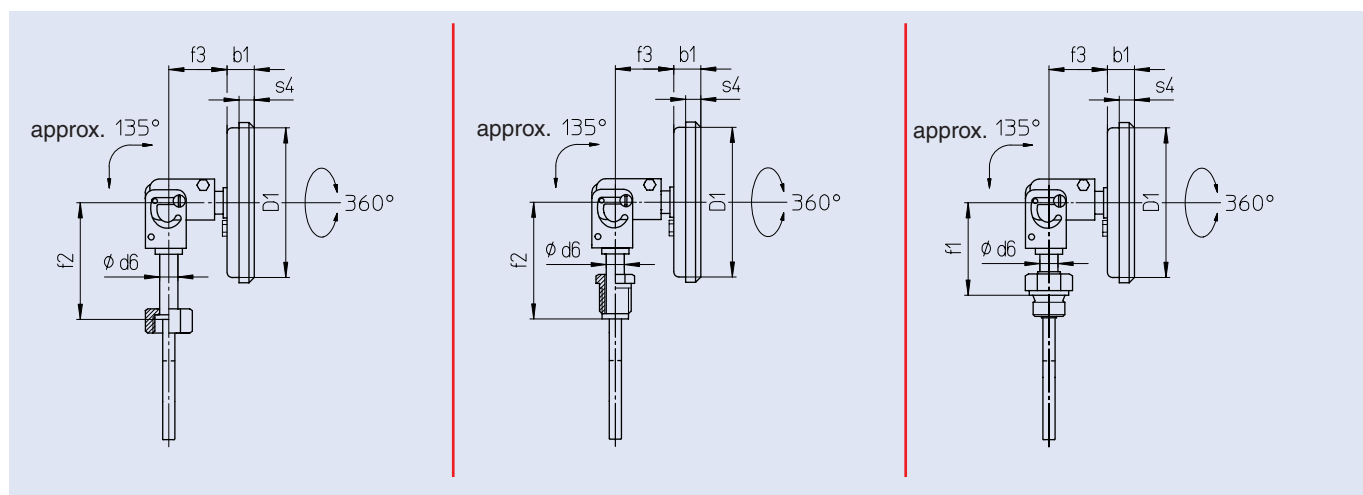

Dimensional Data (mm) and Weights (kg)

NCS	b1	D	D1	d6	d7	f1 ¹⁾	f2 ¹⁾	f3	s4	approx. weight ²⁾	
										TBiGelChg	TBiGelChgG
63	17	67	62	12	14	63	80	40	8	0.28	0.31
80	18	86	79	12	14	63	80	40	8	0.32	0.37
100	18	106	98	12	14	63	80	40	10	0.39	0.46
125	20	136	125	12	14	63	80	40	11	0.49	0.65
160	21	167	159	12	14	63	80	40	11	0.64	0.84

¹⁾ Temperature ranges ≥ 400 °C: extended dimension for small stem lengths, see T08-000-031

²⁾ The data are examples and relate to the version with stem B1, Ø 8 mm, length 100 mm.

